

10

HERRAMIENTA INOX
INOX (STAINLESS STEEL) TOOLS
OUTILLAGE INOX
INOX WERKZEUGE
UTENSILI INOX
FERRAMENTA INOX
ИНСТРУМЕНТ ИЗ НЕРЖАВЕЮЩЕЙ СТАЛИ



BOLA SERIE LARGA / LONG PATTERN BALLPOINT / SÉRIE LONGUE À TÊTE SPHÉRIQUE / KUGELKOPF- INBUSSCHLÜSSEL / SERIE LUNGA CON TESTA SFERICA / ESFERICAS, SERIE LONGA / ДЛИННЫЙ С ШАРОВОЙГОЛОВКОЙ

NI

| COD. | AF mm | L (mm) | A (mm) | g |
|-------|-------|--------|--------|-----|
| 38640 | 1,5 | 65 | 16 | 6 |
| 38641 | 2 | 75 | 18 | 6 |
| 38642 | 2,5 | 90 | 21 | 7 |
| 38643 | 3 | 95 | 23 | 14 |
| 38644 | 4 | 105 | 29 | 24 |
| 38645 | 5 | 120 | 33 | 38 |
| 38646 | 5,5 | 130 | 38 | 50 |
| 38647 | 6 | 141 | 38 | 60 |
| 38648 | 8 | 158 | 44 | 140 |
| 38649 | 10 | 180 | 50 | 220 |



CON MANGO EN T / T-HANDLE / AVEC POIGNÉE EN T / T-GRIFF / CON IMPUGNATURA A T / COM CABO EM T / T-РУЧКА

NI

| COD. | mm | L (mm) | L1 (mm) | L2 (mm) | L3 (mm) | g |
|-------|-----|--------|---------|---------|---------|-----|
| 38630 | 2,5 | | | | | 35 |
| 38631 | 3 | 175 | 115 | | | 40 |
| 38632 | 4 | | | | | 50 |
| 38633 | 5,5 | | | | | 75 |
| 38634 | 6 | | | 60 | 110 | 100 |
| 38635 | 7 | | | | | 120 |
| 38636 | 8 | 185 | 125 | | | 135 |
| 38637 | 9 | | | | | 155 |
| 38638 | 10 | | | | | 180 |

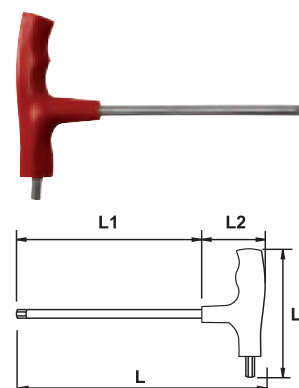

LLAVES DE VASO / SOCKET WRENCHES / DOUILLES / STECKSCHLÜSSEL / BUSSOLE DOPPEN / CHAVES DE CAIXA / ГОЛОВКИ

- 1/4"
- STANDARD
- MM
- 6 PT.

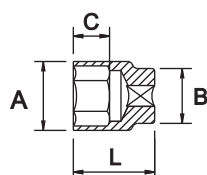

NI

| COD. | AF mm | L (mm) | A (mm) | B (mm) | C (mm) | Pt | g |
|-------|-------|--------|--------|--------|--------|----|----|
| 38235 | 4 | | 7 | | | | |
| 38236 | 5 | | 8 | | | | 20 |
| 38237 | 6 | | 10 | 12 | | | |
| 38238 | 7 | 23 | 12 | | 15 | | |
| 38239 | 8 | | | | | | 30 |
| 38240 | 9 | | 15 | 15 | | 6 | |
| 38241 | 10 | | | | | | |
| 38242 | 11 | | 17 | 17 | | | 40 |
| 38243 | 12 | 25 | 19 | 19 | 17 | | |
| 38244 | 13 | | | | | | 50 |
| 38245 | 14 | | 20 | 20 | | | |



10

HERRAMIENTA INOX
INOX (STAINLESS STEEL) TOOLS
OUTILLAGE INOX
INOX WERKZEUGE
UTENSILI INOX
FERRAMENTA INOX
ИНСТРУМЕНТ ИЗ НЕРЖАВЕЮЩЕЙ СТАЛИ



1/4"

12 PT.

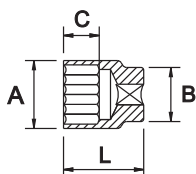

| COD. | AF mm | L (mm) | A (mm) | B (mm) | C (mm) | Pt | g |
|-------|-------|--------|--------|--------|--------|----|----|
| 38403 | 4 | 23 | 7 | 12 | 15 | 12 | 30 |
| 38404 | 5 | | 8 | | | | |
| 38405 | 6 | | 10 | | | | |
| 38406 | 7 | | 12 | | | | |
| 38407 | 8 | 25 | 15 | 17 | 17 | 40 | 50 |
| 38408 | 9 | | 15 | | | | |
| 38409 | 10 | | 15 | | | | |
| 38410 | 11 | | 17 | | | | |
| 38411 | 12 | 25 | 19 | 19 | 17 | 40 | 50 |
| 38412 | 13 | | 19 | | | | |
| 38413 | 14 | | 20 | | | | |



INCH

6 PT.

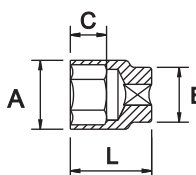

| COD. | AF inch | L (mm) | A (mm) | B (mm) | C (mm) | Pt | g |
|-------|---------|--------|--------|--------|--------|----|----|
| 38246 | 3/16 | 23 | 9 | 12 | 15 | 6 | 30 |
| 38247 | 7/32 | | 9 | | | | |
| 38248 | 1/4 | | 10 | | | | |
| 38249 | 5/16 | | 12 | | | | |
| 38250 | 3/8 | 25 | 15 | 17 | 17 | 40 | 50 |
| 38251 | 7/16 | | 17 | | | | |
| 38252 | 1/2 | | 19 | | | | |
| 38253 | 9/16 | | 21 | | | | |



12 PT.

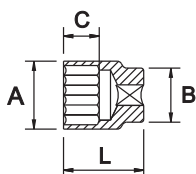

| COD. | AF inch | L (mm) | A (mm) | B (mm) | C (mm) | Pt | g |
|-------|---------|--------|--------|--------|--------|----|----|
| 38414 | 3/16 | 23 | 9 | 12 | 15 | 12 | 30 |
| 38415 | 7/32 | | 9 | | | | |
| 38416 | 1/4 | | 10 | | | | |
| 38417 | 5/16 | | 12 | | | | |
| 38418 | 3/8 | 25 | 15 | 17 | 17 | 40 | 50 |
| 38419 | 7/16 | | 17 | | | | |
| 38420 | 1/2 | | 19 | | | | |
| 38421 | 9/16 | | 21 | | | | |



Si no encuentra el artículo que necesita, consúltenos en info@egamaster.com o en www.egamaster.com
If you can't find the item you look for, please ask us in info@egamaster.com or in www.egamaster.com
Si vous ne trouvez pas l'article que vous desirez, consultez-nous a info@egamaster.com ou a www.egamaster.com



10

HERRAMIENTA INOX
INOX (STAINLESS STEEL) TOOLS
OUTILLAGE INOX
INOX WERKZEUGE
UTENSILI INOX
FERRAMENTA INOX
ИНСТРУМЕНТ ИЗ НЕРЖАВЕЮЩЕЙ СТАЛИ



1/4"

■ **SERIE LARGA / LONG PATTERN / SÉRIE LONGUE / LANGE SERIE / SERIE LUNGA / SERIE LONGA / ДЛИННЫЙ**

■ **MM**

■ **6 PT.**

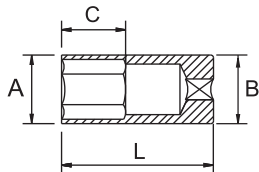

| COD. | AF mm | L (mm) | A (mm) | B (mm) | C (mm) | Pt | g |
|-------|-------|--------|--------|--------|--------|----|----|
| 38254 | 4 | 50 | 12 | 12 | 13 | 6 | 30 |
| 38255 | 5 | | | | | | |
| 38256 | 6 | | | | | | |
| 38257 | 7 | | | | | | |
| 38258 | 8 | | | | | | |
| 38259 | 9 | | | | | | |
| 38260 | 10 | 50 | 15 | 15 | 13 | 6 | 40 |
| 38261 | 11 | | | | | | |
| 38262 | 12 | | | | | | |
| 38204 | 13 | | | | | | |
| 38263 | 14 | | | | | | |
| | | | | 17 | | | |
| | | | 19 | 19 | | | 60 |
| | | | 21 | 21 | | | 80 |



■ **12 PT.**

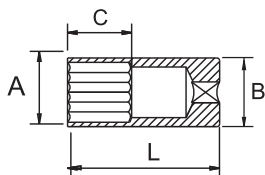

| COD. | AF mm | L (mm) | A (mm) | B (mm) | C (mm) | Pt | g |
|-------|-------|--------|--------|--------|--------|----|----|
| 38422 | 4 | 50 | 12 | 12 | 13 | 12 | 30 |
| 38423 | 5 | | | | | | |
| 38424 | 6 | | | | | | |
| 38425 | 7 | | | | | | |
| 38426 | 8 | | | | | | |
| 38427 | 9 | | | | | | |
| 38428 | 10 | 50 | 15 | 15 | 13 | 12 | 40 |
| 38429 | 11 | | | | | | |
| 38430 | 12 | | | | | | |
| 38431 | 13 | | | | | | |
| 38432 | 14 | | | | | | |
| | | | | 17 | | | |
| | | | 19 | 19 | | | 60 |
| | | | 21 | 21 | | | 80 |



10

HERRAMIENTA INOX
INOX (STAINLESS STEEL) TOOLS
OUTILLAGE INOX
INOX WERKZEUGE
UTENSILI INOX
FERRAMENTA INOX
ИНСТРУМЕНТ ИЗ НЕРЖАВЕЮЩЕЙ СТАЛИ



1/4"

■ INCH

■ 6 PT.

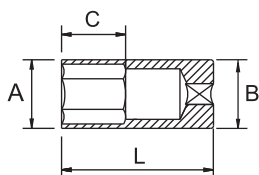

| COD. | AF inch | L (mm) | A (mm) | B (mm) | C (mm) | Pt | g | |
|-------|---------|--------|--------|--------|--------|----|----|----|
| 38264 | 3/16 | 50 | 12 | 12 | 13 | 6 | 30 | |
| 38265 | 7/32 | | | | | | | |
| 38266 | 1/4 | | | | | | | |
| 38267 | 5/16 | | | | | | | |
| 38268 | 3/8 | | 15 | 15 | | | | 50 |
| 38269 | 7/16 | | 17 | 17 | | | | 60 |
| 38270 | 1/2 | | 19 | 19 | | | | 90 |
| 38271 | 9/16 | 21 | 21 | | | | | |



■ 12 PT.

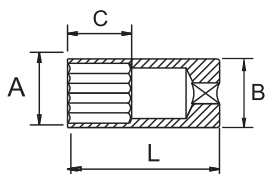

| COD. | AF inch | L (mm) | A (mm) | B (mm) | C (mm) | Pt | g | |
|-------|---------|--------|--------|--------|--------|----|----|----|
| 38433 | 3/16 | 50 | 12 | 12 | 13 | 12 | 30 | |
| 38434 | 7/32 | | | | | | | |
| 38435 | 1/4 | | | | | | | |
| 38436 | 5/16 | | | | | | | |
| 38437 | 3/8 | | 15 | 15 | | | | 50 |
| 38438 | 7/16 | | 17 | 17 | | | | 60 |
| 38439 | 1/2 | | 19 | 19 | | | | 90 |
| 38440 | 9/16 | 21 | 21 | | | | | |



LLAVE DE CARRACA REVERSIBLE / REVERSIBLE RATCHET HANDLE / CLÉ À CLIQUET RÉVERSIBLE / UMSCHALTKNARRE / CHIAVE A CRICCO REVERSIBILE / ROQUETE REVERSIVEL / РЕВЕРСИВНАЯ ТРЕЩЕТКА

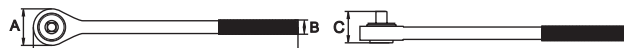

| COD. | AF inch | L (mm) | A (mm) | B (mm) | C (mm) | g | Box |
|-------|---------|--------|--------|--------|--------|-----|-----|
| 38203 | 1/4 | 200 | 32 | 15 | 27 | 260 | 1 |



Si no encuentra el artículo que necesita, consúltenos en info@egamaster.com o en www.egamaster.com
If you can't find the item you look for, please ask us in info@egamaster.com or in www.egamaster.com
Si vous ne trouvez pas l'article que vous desirez, consultez-nous a info@egamaster.com ou a www.egamaster.com



10

HERRAMIENTA INOX
INOX (STAINLESS STEEL) TOOLS
OUTILLAGE INOX
INOX WERKZEUGE
UTENSILI INOX
FERRAMENTA INOX
ИНСТРУМЕНТ ИЗ НЕРЖАВЕЮЩЕЙ СТАЛИ



- 3/8"
- STANDARD
- MM
- 6 PT.

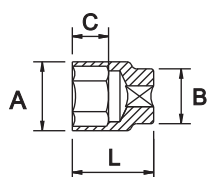

| COD. | AF mm | L (mm) | A (mm) | B (mm) | C (mm) | Pt | g |
|-------|-------|--------|--------|--------|--------|----|-----|
| 38274 | 6 | | 11 | | | | |
| 38275 | 7 | | 12 | | | | 40 |
| 38276 | 8 | | 13 | | | | |
| 38277 | 9 | | 14 | | | | 50 |
| 38278 | 10 | 31 | 15 | 21 | | | |
| 38279 | 11 | | 16 | | | | |
| 38280 | 12 | | 17 | | | | 70 |
| 38281 | 13 | | 18 | | | 6 | |
| 38282 | 14 | | 21 | | | | |
| 38283 | 15 | | 22 | | | | 90 |
| 38284 | 16 | 34 | 22 | 22 | | | |
| 38285 | 17 | | 24 | 24 | | | 100 |
| 38286 | 19 | | 26 | | | | 110 |
| 38287 | 20 | 38 | 27 | 25 | | | |
| 38288 | 22 | | 30 | | 22 | | 120 |



■ 12 PT.

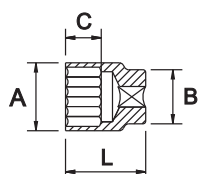

| COD. | AF mm | L (mm) | A (mm) | B (mm) | C (mm) | Pt | g |
|-------|-------|--------|--------|--------|--------|----|-----|
| 38443 | 6 | | 11 | | | | |
| 38444 | 7 | | 12 | | | | 40 |
| 38445 | 8 | | 13 | | | | |
| 38446 | 9 | | 14 | | | | 50 |
| 38447 | 10 | 31 | 15 | 21 | | | |
| 38448 | 11 | | 16 | | | | |
| 38449 | 12 | | 17 | | | | 70 |
| 38450 | 13 | | 18 | | | 12 | |
| 38451 | 14 | | 21 | | | | |
| 38452 | 15 | | 22 | | | | 90 |
| 38453 | 16 | 34 | 22 | 22 | | | |
| 38454 | 17 | | 24 | 24 | | | 100 |
| 38455 | 19 | | 26 | | | | 110 |
| 38456 | 20 | 38 | 27 | 25 | | | |
| 38457 | 22 | | 30 | | 22 | | 120 |



10

HERRAMIENTA INOX
INOX (STAINLESS STEEL) TOOLS
OUTILLAGE INOX
INOX WERKZEUGE
UTENSILI INOX
FERRAMENTA INOX
ИНСТРУМЕНТ ИЗ НЕРЖАВЕЮЩЕЙ СТАЛИ



3/8"

■ INCH

■ 6 PT.

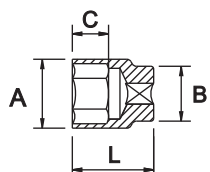

| COD. | AF inch | L (mm) | A (mm) | B (mm) | C (mm) | Pt | g | |
|-------|---------|--------|--------|--------|--------|----|-----|----|
| 38289 | 1/4 | | 11 | | | | 30 | |
| 38290 | 5/16 | | 13 | | | | 40 | |
| 38291 | 3/8 | 31 | 15 | 21 | | 6 | 50 | |
| 38292 | 7/16 | | 16 | | | | | |
| 38293 | 1/2 | | 18 | | | | | |
| 38294 | 9/16 | 34 | 21 | | | | 70 | |
| 38295 | 5/8 | | 22 | | | | | 22 |
| 38296 | 11/16 | | 24 | | | | | 24 |
| 38297 | 3/4 | 38 | 26 | 25 | | | 110 | |
| 38298 | 13/16 | | 28 | | | | | 22 |



■ 12 PT.

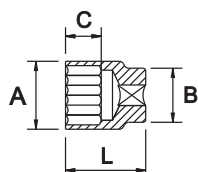

| COD. | AF inch | L (mm) | A (mm) | B (mm) | C (mm) | Pt | g | |
|-------|---------|--------|--------|--------|--------|----|-----|----|
| 38458 | 1/4 | | 11 | | | | 30 | |
| 38459 | 5/16 | | 13 | | | | 40 | |
| 38460 | 3/8 | 31 | 15 | 21 | | 12 | 50 | |
| 38461 | 7/16 | | 16 | | | | | |
| 38462 | 1/2 | | 18 | | | | | |
| 38463 | 9/16 | 34 | 21 | | | | 70 | |
| 38464 | 5/8 | | 22 | | | | | 22 |
| 38465 | 11/16 | | 24 | | | | | 24 |
| 38466 | 3/4 | 38 | 26 | 25 | | | 110 | |
| 38467 | 13/16 | | 28 | | | | | 22 |



Si no encuentra el artículo que necesita, consúltenos en info@egamaster.com o en www.egamaster.com
 If you can't find the item you look for, please ask us in info@egamaster.com or in www.egamaster.com
 Si vous ne trouvez pas l'article que vous desirez, consultez-nous à info@egamaster.com ou à www.egamaster.com



10

HERRAMIENTA INOX
INOX (STAINLESS STEEL) TOOLS
OUTILLAGE INOX
INOX WERKZEUGE
UTENSILI INOX
FERRAMENTA INOX
ИНСТРУМЕНТ ИЗ НЕРЖАВЕЮЩЕЙ СТАЛИ



3/8"

■ **SERIE LARGA / LONG PATTERN / SÉRIE LONGUE / LANGE SERIE / SERIE LUNGA / SERIE LONGA / ДЛИННЫЙ**

■ **MM**

■ **6 PT.**

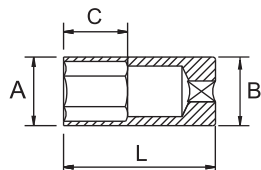

| COD. | AF mm | L (mm) | A (mm) | B (mm) | C (mm) | Pt | g |
|-------|-------|--------|--------|--------|--------|----|-----|
| 38301 | 6 | 60 | 11 | 21 | | 6 | 110 |
| 38302 | 7 | | 12 | | | | |
| 38303 | 8 | | 13 | | | | |
| 38304 | 9 | | 14 | | | | |
| 38305 | 10 | 65 | 15 | | | | |
| 38306 | 11 | | 16 | | | | |
| 38307 | 12 | | 17 | | | | |
| 38308 | 13 | | 18 | | | | |
| 38309 | 14 | 70 | 21 | | | | |
| 38310 | 15 | | 22 | | | | |
| 38311 | 16 | | 22 | | | | |
| 38312 | 17 | | 24 | | | | |
| 38313 | 19 | 70 | 26 | 25 | | | 160 |
| 38314 | 20 | | 27 | | | | |
| 38315 | 22 | | 30 | | | | |
| | | | | | | | |



■ **12 PT.**

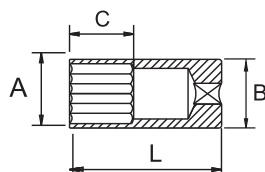

| COD. | AF mm | L (mm) | A (mm) | B (mm) | C (mm) | Pt | g |
|-------|-------|--------|--------|--------|--------|----|-----|
| 38470 | 6 | 60 | 11 | 21 | | 6 | 110 |
| 38471 | 7 | | 12 | | | | |
| 38472 | 8 | | 13 | | | | |
| 38473 | 9 | | 14 | | | | |
| 38474 | 10 | 65 | 15 | | | | |
| 38475 | 11 | | 16 | | | | |
| 38476 | 12 | | 17 | | | | |
| 38477 | 13 | | 18 | | | | |
| 38478 | 14 | 70 | 21 | | | | |
| 38479 | 15 | | 22 | | | | |
| 38480 | 16 | | 22 | | | | |
| 38481 | 17 | | 24 | | | | |
| 38482 | 19 | 70 | 26 | 25 | | | 160 |
| 38483 | 20 | | 27 | | | | |
| 38484 | 22 | | 30 | | | | |
| | | | | | | | |



10

HERRAMIENTA INOX
INOX (STAINLESS STEEL) TOOLS
OUTILLAGE INOX
INOX WERKZEUGE
UTENSILI INOX
FERRAMENTA INOX
ИНСТРУМЕНТ ИЗ НЕРЖАВЕЮЩЕЙ СТАЛИ



3/8"

■ INCH

■ 6 PT.

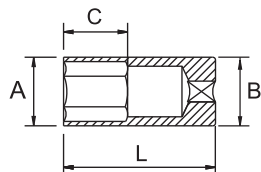

| COD. | AF inch | L (mm) | A (mm) | B (mm) | C (mm) | Pt | g |
|-------|---------|--------|--------|--------|--------|----|-----|
| 38316 | 1/4 | 60 | 11 | 21 | | | |
| 38317 | 5/16 | | 13 | | | | |
| 38318 | 3/8 | | 15 | | | | |
| 38319 | 7/16 | 65 | 16 | | | 6 | 110 |
| 38320 | 1/2 | | 18 | | | | |
| 38321 | 9/16 | | 21 | | | | |
| 38322 | 5/8 | 70 | 22 | 22 | | | 120 |
| 38323 | 11/16 | | 24 | 24 | | | 140 |
| 38324 | 3/4 | | 26 | 25 | | | 160 |
| 38325 | 13/16 | | 28 | | 26 | | 200 |



■ 12 PT.

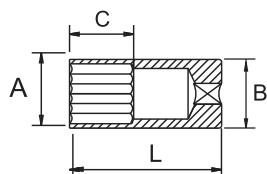

| COD. | AF inch | L (mm) | A (mm) | B (mm) | C (mm) | Pt | g |
|-------|---------|--------|--------|--------|--------|----|-----|
| 38485 | 1/4 | 60 | 11 | 21 | | | |
| 38486 | 5/16 | | 13 | | | | |
| 38487 | 3/8 | | 15 | | | | |
| 38488 | 7/16 | 65 | 16 | | | 12 | 110 |
| 38489 | 1/2 | | 18 | | | | |
| 38490 | 9/16 | | 21 | | | | |
| 38491 | 5/8 | 70 | 22 | 22 | | | 120 |
| 38492 | 11/16 | | 24 | 24 | | | 140 |
| 38493 | 3/4 | | 26 | 25 | | | 160 |
| 38494 | 13/16 | | 28 | | 26 | | 200 |



■ 1/2"

■ STANDARD

■ MM

■ 6 PT.

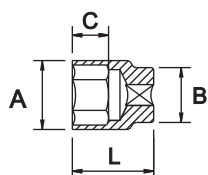

| COD. | AF mm | L (mm) | A (mm) | B (mm) | C (mm) | Pt | g |
|-------|-------|--------|--------|--------|--------|----|----|
| 38326 | 6 | 38 | 12 | 24 | 23 | 6 | 40 |
| 38327 | 7 | | 13 | | | | |
| 38328 | 8 | | 14 | | | | |
| 38329 | 9 | | 15 | | | | |



Si no encuentra el artículo que necesita, consúltenos en info@egamaster.com o en www.egamaster.com
 If you can't find the item you look for, please ask us in info@egamaster.com or in www.egamaster.com
 Si vous ne trouvez pas l'article que vous desirez, consultez-nous a info@egamaster.com ou a www.egamaster.com



10

HERRAMIENTA INOX
INOX (STAINLESS STEEL) TOOLS
OUTILLAGE INOX
INOX WERKZEUGE
UTENSILI INOX
FERRAMENTA INOX
ИНСТРУМЕНТ ИЗ НЕРЖАВЕЮЩЕЙ СТАЛИ



1/2"

| COD. | AF mm | L (mm) | A (mm) | B (mm) | C (mm) | Pt | g |
|-------|-------|--------|--------|--------|--------|----|-----|
| 38330 | 10 | | 15 | | | | |
| 38331 | 11 | | 16 | | | | |
| 38332 | 12 | | 18 | | | | 60 |
| 38187 | 13 | | 19 | 24 | | | |
| 38333 | 14 | | 20 | | | | |
| 38334 | 15 | | 21 | | | | 70 |
| 38335 | 16 | | 24 | | | | |
| 38188 | 17 | | 25 | 25 | | | 80 |
| 38336 | 18 | 38 | 26 | | | | 90 |
| 38189 | 19 | | 27 | | | | |
| 38337 | 20 | | 28 | | | | 100 |
| 38338 | 21 | | 29 | 26 | 23 | 6 | |
| 38190 | 22 | | 30 | | | | 110 |
| 38339 | 23 | | 32 | | | | 150 |
| 38198 | 24 | | 33 | | | | |
| 38340 | 25 | | 36 | 28 | | | 160 |
| 38341 | 26 | | 37 | 29 | | | |
| 38199 | 27 | | 38 | 30 | | | 170 |
| 38342 | 28 | | 40 | 31 | | | 190 |
| 38343 | 29 | 40 | 40 | 31 | | | 200 |
| 38221 | 30 | | 43 | 32 | | | 230 |
| 38222 | 32 | | 50 | 37 | | | 300 |
| 38223 | 36 | 43 | | | | | |

12 PT.

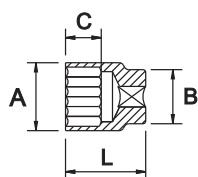

| COD. | AF mm | L (mm) | A (mm) | B (mm) | C (mm) | Pt | g |
|-------|-------|--------|--------|--------|--------|----|-----|
| 38495 | 6 | | 12 | | | | 60 |
| 38496 | 7 | | 13 | | | | |
| 38497 | 8 | | 14 | | | | 55 |
| 38498 | 9 | | 15 | | | | |
| 38499 | 10 | | 16 | 24 | | | 58 |
| 38500 | 11 | | 18 | | | | |
| 38501 | 12 | | 19 | | | | 60 |
| 38502 | 13 | | 20 | | | | |
| 38503 | 14 | | 21 | | | | |
| 38504 | 15 | | 24 | | | | 70 |
| 38505 | 16 | 38 | 25 | 25 | | | 80 |
| 38506 | 17 | | 26 | | | | |
| 38507 | 18 | | 27 | | 23 | 12 | 100 |
| 38508 | 19 | | 28 | | | | 75 |
| 38509 | 20 | | 29 | 26 | | | 80 |
| 38510 | 21 | | 30 | | | | 110 |
| 38511 | 22 | | 32 | | | | 150 |
| 38512 | 23 | | 33 | | | | |
| 38513 | 24 | | 36 | 28 | | | 160 |
| 38514 | 25 | | 37 | 29 | | | |
| 38515 | 26 | | 38 | 30 | | | 170 |
| 38516 | 27 | | 40 | 31 | | | 190 |
| 38517 | 28 | 40 | 40 | 31 | | | 200 |
| 38518 | 29 | | 43 | 32 | | | 230 |
| 38519 | 30 | | 50 | 37 | | | 300 |
| 38520 | 32 | | | | | | |
| 38521 | 36 | 43 | | | | | |



10

HERRAMIENTA INOX
INOX (STAINLESS STEEL) TOOLS
OUTILLAGE INOX
INOX WERKZEUGE
UTENSILI INOX
FERRAMENTA INOX
ИНСТРУМЕНТ ИЗ НЕРЖАВЕЮЩЕЙ СТАЛИ



1/2"

■ INCH

■ 6 PT.

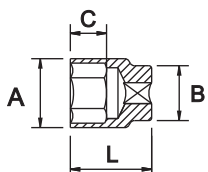

| COD. | AF inch | L (mm) | A (mm) | B (mm) | C (mm) | Pt | g |
|-------|---------|--------|--------|--------|--------|----|-----|
| 38344 | 1/4 | | 12 | | | | 40 |
| 38345 | 5/16 | | 13 | | | | 50 |
| 38346 | 3/8 | | 15 | | | | |
| 38347 | 7/16 | | 16 | | | | 60 |
| 38348 | 1/2 | | 19 | 24 | | | |
| 38349 | 9/16 | | 20 | | | | |
| 38350 | 19/32 | | 22 | | | | 70 |
| 38351 | 5/8 | 38 | 24 | | | | |
| 38352 | 11/16 | | 25 | | | | |
| 38353 | 3/4 | | 27 | | | | 80 |
| 38354 | 25/32 | | 28 | 25 | 23 | 6 | |
| 38355 | 13/16 | | 29 | | | | 90 |
| 38356 | 7/8 | | 30 | | | | 110 |
| 38357 | 15/16 | | 33 | 26 | | | 150 |
| 38358 | 1 | | 35 | 28 | | | 160 |
| 38359 | 1.1/16 | | 36 | 29 | | | 170 |
| 38360 | 1.1/8 | 40 | 40 | 31 | | | 190 |
| 38361 | 1.3/16 | | | | | | |
| 38362 | 1.1/4 | | 43 | 32 | | | 230 |
| 38363 | 1.7/16 | 43 | 50 | 37 | | | 300 |



■ 12 PT.

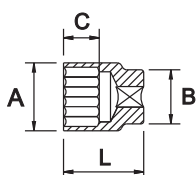

| COD. | AF inch | L (mm) | A (mm) | B (mm) | C (mm) | Pt | g |
|-------|---------|--------|--------|--------|--------|----|-----|
| 38522 | 1/4 | | 12 | | | | 40 |
| 38523 | 5/16 | | 13 | | | | 50 |
| 38524 | 3/8 | | 15 | | | | |
| 38525 | 7/16 | | 16 | | | | 60 |
| 38526 | 1/2 | | 19 | 24 | | | |
| 38527 | 9/16 | | 20 | | | | |
| 38528 | 19/32 | | 22 | | | | 70 |
| 38529 | 5/8 | 38 | 24 | | | | |
| 38530 | 11/16 | | 25 | | | | |
| 38531 | 3/4 | | 27 | | | | 80 |
| 38532 | 25/32 | | 28 | 25 | 23 | 12 | |
| 38533 | 13/16 | | 29 | | | | 90 |
| 38534 | 7/8 | | 30 | | | | 110 |
| 38535 | 15/16 | | 33 | 26 | | | 150 |
| 38536 | 1 | | 35 | 28 | | | 160 |
| 38537 | 1.1/16 | | 36 | 29 | | | 170 |
| 38538 | 1.1/8 | 40 | 40 | 31 | | | 190 |
| 38539 | 1.3/16 | | | | | | |
| 38540 | 1.1/4 | | 43 | 32 | | | 230 |
| 38541 | 1.7/16 | 43 | 50 | 37 | | | 300 |



Si no encuentra el artículo que necesita, consúltenos en info@egamaster.com o en www.egamaster.com
If you can't find the item you look for, please ask us in info@egamaster.com or in www.egamaster.com
Si vous ne trouvez pas l'article que vous desirez, consultez-nous a info@egamaster.com ou a www.egamaster.com



10

HERRAMIENTA INOX
INOX (STAINLESS STEEL) TOOLS
OUTILLAGE INOX
INOX WERKZEUGE
UTENSILI INOX
FERRAMENTA INOX
ИНСТРУМЕНТ ИЗ НЕРЖАВЕЮЩЕЙ СТАЛИ



1/2"

■ SERIE LARGA / LONG PATTERN / SÉRIE LONGUE / LANGE SERIE / SERIE LUNGA / SERIE LONGA / ДЛИННЫЙ

■ MM

■ 6 PT.

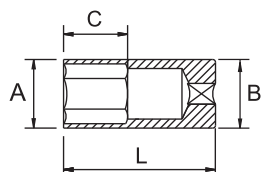

| COD. | AF mm | L (mm) | A (mm) | B (mm) | C (mm) | Pt | g |
|-------|-------|--------|--------|--------|--------|----|-----|
| 38364 | 6 | | 12 | | | | |
| 38365 | 7 | | 13 | | | | |
| 38366 | 8 | | 14 | | | | |
| 38367 | 9 | | 15 | | | | |
| 38368 | 10 | | 16 | | | | 160 |
| 38369 | 11 | | 18 | 24 | | | |
| 38370 | 12 | | 19 | | | 29 | |
| 38371 | 13 | | 20 | | | | |
| 38372 | 14 | | 21 | | | | |
| 38373 | 15 | | 24 | | | | 170 |
| 38374 | 16 | | 25 | 25 | | | |
| 38224 | 17 | | 26 | | | | 180 |
| 38375 | 18 | | 27 | | | | 190 |
| 38205 | 19 | 85 | 28 | | | 6 | |
| 38376 | 20 | | 29 | 26 | | | 220 |
| 38377 | 21 | | 30 | | | | 230 |
| 38225 | 22 | | 32 | | | | 250 |
| 38378 | 23 | | 33 | 27 | | | 270 |
| 38226 | 24 | | 35 | 28 | | | 330 |
| 38379 | 25 | | 36 | 29 | | 32 | |
| 38380 | 26 | | 38 | 30 | | | 340 |
| 38227 | 27 | | 40 | 31 | | | 360 |
| 38381 | 28 | | 43 | 32 | | | 370 |
| 38382 | 29 | | 50 | 37 | | | 390 |
| 38228 | 30 | | | | | | |
| 38229 | 32 | | | | | | |
| 38230 | 36 | | | | | | |



■ 12 PT.

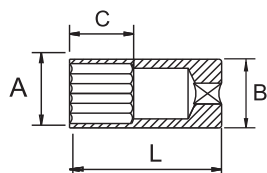

| COD. | AF mm | L (mm) | A (mm) | B (mm) | C (mm) | Pt | g |
|-------|-------|--------|--------|--------|--------|----|-----|
| 38542 | 6 | | 12 | | | | |
| 38543 | 7 | | 13 | | | | |
| 38544 | 8 | | 14 | | | | |
| 38545 | 9 | | 15 | | | | |
| 38546 | 10 | | 16 | | | | 160 |
| 38547 | 11 | 85 | 18 | 24 | 29 | 12 | |
| 38548 | 12 | | 19 | | | | |
| 38549 | 13 | | 20 | | | | |
| 38550 | 14 | | 21 | | | | |
| 38551 | 15 | | 24 | | | | 170 |
| 38552 | 16 | | 25 | 25 | | | 180 |
| 38553 | 17 | | | | | | |



10

HERRAMIENTA INOX
INOX (STAINLESS STEEL) TOOLS
OUTILLAGE INOX
INOX WERKZEUGE
UTENSILI INOX
FERRAMENTA INOX
ИНСТРУМЕНТ ИЗ НЕРЖАВЕЮЩЕЙ СТАЛИ



1/2"

| COD. | AF mm | L (mm) | A (mm) | B (mm) | C (mm) | Pt | g | | | | |
|-------|-------|--------|--------|--------|--------|----|-----|----|-----|----|-----|
| 38554 | 18 | 85 | 26 | 26 | 29 | 12 | 190 | | | | |
| 38555 | 19 | | 27 | | | | 26 | 29 | 220 | | |
| 38556 | 20 | | 28 | | | | | | 26 | 29 | 230 |
| 38557 | 21 | | 29 | | | | | | | | 26 |
| 38558 | 22 | | 30 | 27 | 29 | | 270 | | | | |
| 38559 | 23 | | 32 | | | | 28 | 29 | 330 | | |
| 38560 | 24 | | 33 | 29 | 29 | | | | 340 | | |
| 38561 | 25 | | 35 | | | | 30 | 29 | 360 | | |
| 38562 | 26 | | 36 | 31 | 29 | | | | 370 | | |
| 38563 | 27 | | 36 | | | | 32 | 29 | 390 | | |
| 38564 | 28 | | 38 | 33 | 29 | | | | | | |
| 38565 | 29 | | 40 | | | | 34 | 29 | | | |
| 38566 | 30 | | 43 | 35 | 29 | | | | | | |
| 38567 | 32 | | 50 | | | | 36 | 29 | | | |
| 38568 | 36 | | | | | | | | | | |

■ INCH

■ 6 PT.

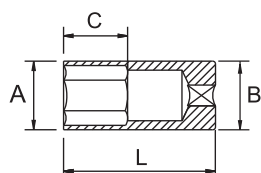

| COD. | AF inch | L (mm) | A (mm) | B (mm) | C (mm) | Pt | g | | | | |
|-------|---------|--------|--------|--------|--------|----|-----|----|-----|----|-----|
| 38383 | 1/4 | 85 | 12 | 24 | 29 | 6 | 160 | | | | |
| 38384 | 5/16 | | 13 | | | | 24 | 29 | 170 | | |
| 38385 | 3/8 | | 15 | | | | | | 24 | 29 | 180 |
| 38386 | 7/16 | | 18 | | | | | | | | 26 |
| 38387 | 1/2 | | 19 | 27 | 29 | | 220 | | | | |
| 38388 | 9/16 | | 21 | | | | 28 | 29 | 240 | | |
| 38389 | 19/32 | | 24 | 29 | 29 | | | | 270 | | |
| 38390 | 5/8 | | 26 | | | | 30 | 29 | 330 | | |
| 38391 | 11/16 | | 27 | 31 | 29 | | | | 350 | | |
| 38392 | 3/4 | | 28 | | | | 32 | 29 | 370 | | |
| 38393 | 25/32 | | 29 | 33 | 29 | | | | 390 | | |
| 38394 | 13/16 | | 30 | | | | 34 | 29 | | | |
| 38395 | 7/8 | | 33 | 35 | 29 | | | | | | |
| 38396 | 15/16 | | 35 | | | | 36 | 29 | | | |
| 38397 | 1 | | 36 | 37 | 29 | | | | | | |
| 38398 | 1.1/16 | | 40 | | | | 38 | 29 | | | |
| 38399 | 1.1/8 | 43 | 39 | 29 | | | | | | | |
| 38400 | 1.3/16 | 50 | | | 40 | 29 | | | | | |
| 38401 | 1.1/4 | | | | | | | | | | |
| 38402 | 1.7/16 | | | | | | | | | | |



Si no encuentra el artículo que necesita, consúltenos en info@egamaster.com o en www.egamaster.com
 If you can't find the item you look for, please ask us in info@egamaster.com or in www.egamaster.com
 Si vous ne trouvez pas l'article que vous desirez, consultez-nous à info@egamaster.com ou à www.egamaster.com



10

HERRAMIENTA INOX
INOX (STAINLESS STEEL) TOOLS
OUTILLAGE INOX
INOX WERKZEUGE
UTENSILI INOX
FERRAMENTA INOX
ИНСТРУМЕНТ ИЗ НЕРЖАВЕЮЩЕЙ СТАЛИ



1/2"

■ 12 PT.

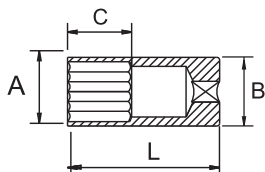

| COD. | AF inch | L (mm) | A (mm) | B (mm) | C (mm) | Pt | g |
|-------|---------|--------|--------|--------|--------|----|-----|
| 38569 | 1/4 | | 12 | | | | 160 |
| 38570 | 5/16 | | 13 | | | | 170 |
| 38571 | 3/8 | | 15 | | | | 180 |
| 38572 | 7/16 | | 18 | 24 | | | 190 |
| 38573 | 1/2 | | 19 | | | | 220 |
| 38574 | 9/16 | | 21 | | 29 | | 240 |
| 38575 | 19/32 | | 24 | | | | 270 |
| 38576 | 5/8 | | 26 | | | | 330 |
| 38577 | 11/16 | | 27 | | | | 350 |
| 38578 | 3/4 | 85 | 28 | 26 | | 12 | 370 |
| 38579 | 25/32 | | 29 | | | | 390 |
| 38580 | 13/16 | | 30 | | | | |
| 38581 | 7/8 | | 33 | | | | |
| 38582 | 15/16 | | 35 | 28 | | | |
| 38583 | 1 | | 36 | 29 | 32 | | |
| 38584 | 1.1/16 | | 40 | 31 | | | |
| 38585 | 1.1/8 | | 43 | 32 | | | |
| 38586 | 1.3/16 | | 50 | 37 | | | |
| 38587 | 1.1/4 | | | | | | |
| 38588 | 1.7/16 | | | | | | |



LLAVE DE CARRACA REVERSIBLE / REVERSIBLE RATCHET HANDLE / CLÉ À CLIQUET RÉVERSIBLE / UMSCHALTKNARRE / CHIAVE A CRICCO REVERSIBILE / ROQUETE REVERSIVEL / РЕВЕРСИВНАЯ ТРЕЩЕТКА



| COD. | AF inch | A (mm) | B (mm) | C (mm) | L (mm) | g |
|-------|---------|--------|--------|--------|--------|-----|
| 38200 | 1/2 | 40 | 20 | 41 | 250 | 550 |



ALARGADERA / EXTENSION / RALLONGE / VERLANGERUNG / PROLUNGA / EXTENCAO / УДЛИНИТЕЛЬ

| COD. | AF inch | L (inch) | g |
|-------|---------|----------|-----|
| 38220 | | 4 | 350 |
| 38824 | 1/2 | 8 | 380 |
| 38825 | | 10 | 460 |



ARTICULACIÓN UNIVERSAL / UNIVERSAL JOINT / CARDAN UNIVERSEL / KARDANGELNENK / SNODO CARDANICO / CARDAN UNIVERSAL / ШАРНИР

| COD. | AF inch | g |
|-------|---------|-----|
| 38829 | 1/2 | 170 |



MANGO CORREDIZO EN "T" / SLIDING "T" HANDLE / POIGNEE COULISSANTE / QUERGRIF / ASTA CON QUADRO SCORREVOLO / CABO "T" CORREDICO / ПОДВИЖНАЯ "Т" РУЧКА

| COD. | AF inch | L (mm) | g |
|-------|---------|--------|-----|
| 38830 | 1/2 | 250 | 330 |



10

HERRAMIENTA INOX
INOX (STAINLESS STEEL) TOOLS
OUTILLAGE INOX
INOX WERKZEUGE
UTENSILI INOX
FERRAMENTA INOX
ИНСТРУМЕНТ ИЗ НЕРЖАВЕЮЩЕЙ СТАЛИ



1/2"

■ **BERBIQUÍ / SPEEDER HANDLE / VILLEBREQUIN / KURBEL / LEVA GIROBECCHINO / MANIVELA / КОЛЕНЧАТАЯ РУЧКА**

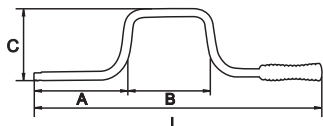

| COD. | AF inch | L (mm) | A (mm) | B (mm) | C (mm) | g | Icon |
|--------------|---------|--------|--------|--------|--------|-----|------|
| 38831 | 1/2 | 380 | 135 | 140 | 100 | 500 | 5 |



■ 3/4"

■ **STANDARD**

■ **MM**

■ **6 PT.**

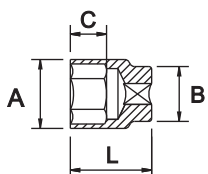

| COD. | AF mm | L (mm) | A (mm) | B (mm) | C (mm) | Pt | g |
|--------------|-------|--------|--------|--------|--------|------|------|
| 38671 | 17 | 50 | 28 | 30 | 14 | 6 | 240 |
| 38672 | 19 | | 30 | 33 | | | |
| 38673 | 21 | | 32 | 36 | | | |
| 38674 | 22 | | 33 | | 15 | | |
| 38675 | 23 | | 34 | | 17 | | |
| 38676 | 24 | 55 | 36 | 42 | 250 | | |
| 38677 | 26 | | 38 | | | 15 | |
| 38678 | 27 | | 39 | 17 | | | |
| 38679 | 28 | | 40 | 24 | | 260 | |
| 38680 | 29 | | 42 | 38 | | 280 | |
| 38681 | 30 | 70 | 44 | 38 | 26 | 320 | |
| 38682 | 32 | | 42 | 29 | | | 330 |
| 38683 | 36 | | 50 | 43 | 450 | | |
| 38684 | 38 | | 55 | 45 | 500 | | |
| 38685 | 41 | | 65 | 55 | 45 | | 34 |
| 38686 | 46 | 75 | 60 | 48 | 37 | 700 | |
| 38687 | 50 | | 70 | | 38 | 900 | |
| 38688 | 55 | | 75 | 75 | 41 | 41 | 1050 |
| 38689 | 60 | 80 | 80 | 45 | 45 | 1150 | |



■ **12 PT.**

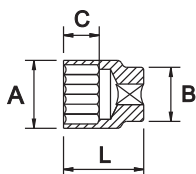

| COD. | AF mm | L (mm) | A (mm) | B (mm) | C (mm) | Pt | g |
|--------------|-------|--------|--------|--------|--------|-----|-----|
| 38709 | 17 | 50 | 28 | 30 | 14 | 12 | 240 |
| 38710 | 19 | | 30 | 33 | | | |
| 38711 | 21 | | 32 | 36 | | | |
| 38712 | 22 | | 33 | | 15 | | |
| 38713 | 23 | | 34 | | 17 | | |
| 38714 | 24 | 75 | 36 | 48 | 17 | 250 | |
| 38715 | 26 | | 75 | | 48 | 41 | 41 |



Si no encuentra el artículo que necesita, consúltenos en info@egamaster.com o en www.egamaster.com
 If you can't find the item you look for, please ask us in info@egamaster.com or in www.egamaster.com
 Si vous ne trouvez pas l'article que vous desirez, consultez-nous a info@egamaster.com ou a www.egamaster.com



10

HERRAMIENTA INOX
INOX (STAINLESS STEEL) TOOLS
OUTILLAGE INOX
INOX WERKZEUGE
UTENSILI INOX
FERRAMENTA INOX
ИНСТРУМЕНТ ИЗ НЕРЖАВЕЮЩЕЙ СТАЛИ



3/4"

| COD. | AF mm | L (mm) | A (mm) | B (mm) | C (mm) | Pt | g | | |
|-------|-------|--------|--------|--------|--------|----|------|-----|-----|
| 38716 | 27 | 50 | 38 | 36 | 24 | 12 | 250 | | |
| 38717 | 28 | | 39 | | | | 260 | | |
| 38718 | 29 | | 40 | | | | 280 | | |
| 38719 | 30 | 55 | 42 | 38 | 320 | | | | |
| 38720 | 32 | | 44 | | 330 | | | | |
| 38721 | 36 | | 50 | | 42 | | 29 | 450 | |
| 38722 | 38 | 65 | 43 | 43 | 31 | | 500 | | |
| 38723 | 41 | | 55 | | | | 45 | 34 | 600 |
| 38724 | 46 | | 60 | | | | 37 | 700 | |
| 38725 | 50 | 70 | 70 | 48 | 38 | | 900 | | |
| 38726 | 55 | 75 | 75 | | 40 | | 1050 | | |
| 38727 | 60 | 80 | 80 | | 45 | | 1150 | | |

- INCH
- 6 PT.

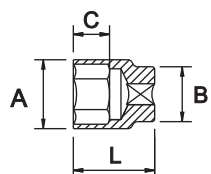

| COD. | AF inch | L (mm) | A (mm) | B (mm) | C (mm) | Pt | g |
|-------|---------|--------|--------|--------|--------|-----|------|
| 38690 | 3/4 | 50 | 30 | 36 | 17 | 6 | 240 |
| 38691 | 13/16 | | 33 | | | | 250 |
| 38692 | 7/8 | | 35 | | | | 250 |
| 38693 | 15/16 | 55 | 38 | 38 | 27 | | 300 |
| 38694 | 1 | | 40 | | | | 320 |
| 38695 | 1.1/16 | | 42 | | | | 280 |
| 38696 | 1.1/8 | 60 | 44 | 42 | 30 | | 430 |
| 38697 | 1.3/16 | | 50 | | | | 490 |
| 38698 | 1.1/4 | | 53 | | | | 550 |
| 38699 | 1.7/16 | 65 | 55 | 45 | 32 | | 600 |
| 38700 | 1.1/2 | | 60 | | | | 550 |
| 38701 | 1.9/16 | | 65 | | | | 35 |
| 38702 | 1.5/8 | 70 | 60 | 47 | 39 | 900 | |
| 38703 | 1.3/4 | | 70 | | | 41 | 900 |
| 38704 | 1.13/16 | | 75 | | | 45 | 950 |
| 38705 | 1.7/8 | 80 | 75 | 48 | 45 | 950 | |
| 38706 | 2 | | 80 | | | 47 | 1000 |
| 38707 | 2.3/16 | | 85 | | | 47 | 1000 |
| 38708 | 2.3/8 | 90 | 85 | 47 | 1000 | | |



- 12 PT.

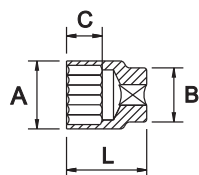

| COD. | AF inch | L (mm) | A (mm) | B (mm) | C (mm) | Pt | g |
|-------|---------|--------|--------|--------|--------|----|-----|
| 38728 | 3/4 | 50 | 30 | 36 | 17 | 12 | 240 |
| 38729 | 13/16 | | 33 | | | | 250 |
| 38730 | 7/8 | | 35 | | | | 250 |
| 38731 | 15/16 | 55 | 38 | 38 | 27 | | 300 |
| 38732 | 1 | | 40 | | | | 320 |
| 38733 | 1.1/16 | | 42 | | | | 280 |



10

HERRAMIENTA INOX
INOX (STAINLESS STEEL) TOOLS
OUTILLAGE INOX
INOX WERKZEUGE
UTENSILI INOX
FERRAMENTA INOX
ИНСТРУМЕНТ ИЗ НЕРЖАВЕЮЩЕЙ СТАЛИ



3/4"

| COD. | AF inch | L (mm) | A (mm) | B (mm) | C (mm) | Pt | g |
|-------|---------|--------|--------|--------|--------|----|------|
| 38734 | 1.1/8 | 50 | 40 | | | | 300 |
| 38735 | 1.3/16 | | 42 | 38 | | | |
| 38736 | 1.1/4 | 55 | 44 | | | | 320 |
| 38737 | 1.7/16 | | | 42 | | | 430 |
| 38738 | 1.1/2 | 60 | 50 | | 30 | | 490 |
| 38739 | 1.9/16 | | 53 | | | | 550 |
| 38740 | 1.5/8 | | 55 | 45 | 32 | 12 | 600 |
| 38741 | 1.3/4 | 65 | | | | | |
| 38742 | 1.13/16 | | 60 | 47 | 35 | | 750 |
| 38743 | 1.7/8 | | 65 | | 39 | | |
| 38744 | 2 | 70 | 70 | | 41 | | 900 |
| 38745 | 2.3/16 | 80 | 75 | 48 | 45 | | 950 |
| 38746 | 2.3/8 | 90 | 85 | | 47 | | 1000 |

■ SERIE LARGA / LONG PATTERN / SÉRIE LONGUE / LANGE SERIE / SERIE LUNGA / SERIE LONGA / ВЫСОКАЯ СЕРИЯ

■ MM

■ 6 PT.

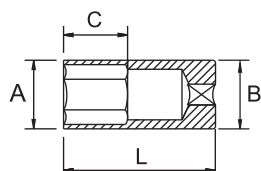

| COD. | AF mm | L (mm) | A (mm) | B (mm) | C (mm) | Pt | g |
|-------|-------|--------|--------|--------|--------|----|------|
| 38747 | 17 | | 28 | | | | 150 |
| 38748 | 19 | | 30 | | | | 320 |
| 38749 | 21 | | | | 29 | | 340 |
| 38750 | 22 | | 33 | 36 | | | 380 |
| 38751 | 23 | | 34 | | | | 400 |
| 38752 | 24 | 49 | 36 | | | | 420 |
| 38753 | 26 | | 38 | 38 | | | |
| 38754 | 27 | | 39 | | 24 | | 440 |
| 38755 | 28 | | 40 | 36 | | | |
| 38756 | 29 | | | | | 6 | 480 |
| 38757 | 30 | | 42 | 38 | | | 530 |
| 38758 | 32 | 54 | 45 | | 29 | | 580 |
| 38759 | 36 | 56 | 50 | 42 | 31 | | 690 |
| 38760 | 38 | | 52 | | 30 | | 720 |
| 38761 | 41 | 60 | 56 | 45 | 34 | | 810 |
| 38762 | 46 | 66 | 62 | | 40 | | 900 |
| 38763 | 50 | 68 | 68 | 48 | 42 | | 1000 |
| 38764 | 55 | 74 | 75 | 53 | 38 | | 1100 |
| 38765 | 60 | 78 | 83 | 57 | 40 | | 1200 |



Si no encuentra el artículo que necesita, consúltenos en info@egamaster.com o en www.egamaster.com
 If you can't find the item you look for, please ask us in info@egamaster.com or in www.egamaster.com
 Si vous ne trouvez pas l'article que vous desirez, consultez-nous a info@egamaster.com ou a www.egamaster.com



10

HERRAMIENTA INOX
INOX (STAINLESS STEEL) TOOLS
OUTILLAGE INOX
INOX WERKZEUGE
UTENSILI INOX
FERRAMENTA INOX
ИНСТРУМЕНТ ИЗ НЕРЖАВЕЮЩЕЙ СТАЛИ



3/4"

12 PT.

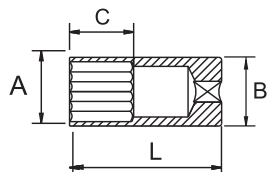

| COD. | AF mm | L (mm) | A (mm) | B (mm) | C (mm) | Pt | g |
|-------|-------|--------|--------|--------|--------|----|------|
| 38785 | 17 | | 28 | | | | 150 |
| 38786 | 19 | | 30 | | | | 320 |
| 38787 | 21 | | | | 29 | | 340 |
| 38788 | 22 | | 33 | 36 | | | 380 |
| 38789 | 23 | | 34 | | | | 400 |
| 38790 | 24 | 49 | 36 | | | | 420 |
| 38791 | 26 | | 38 | 38 | | | |
| 38792 | 27 | | 39 | | 24 | | 440 |
| 38793 | 28 | | 40 | 36 | | | |
| 38794 | 29 | | | | | 12 | 480 |
| 38795 | 30 | | 42 | 38 | | | 530 |
| 38796 | 32 | 54 | 45 | | 29 | | 580 |
| 38797 | 36 | | 50 | 42 | 31 | | 690 |
| 38798 | 38 | 56 | 52 | | 30 | | 720 |
| 38799 | 41 | 60 | 56 | 45 | 34 | | 810 |
| 38800 | 46 | 66 | 62 | | 40 | | 900 |
| 38801 | 50 | 68 | 68 | 48 | 42 | | 1000 |
| 38802 | 55 | 74 | 75 | 53 | 38 | | 1100 |
| 38803 | 60 | 78 | 83 | 57 | 40 | | 1200 |



INCH

6 PT.

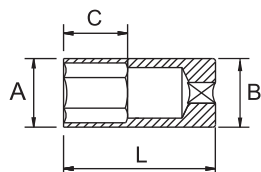

| COD. | AF inch | L (mm) | A (mm) | B (mm) | C (mm) | Pt | g |
|-------|---------|--------|--------|--------|--------|----|------|
| 38766 | 3/4 | | 30 | | | | 320 |
| 38767 | 13/16 | | 33 | | 29 | | 350 |
| 38768 | 7/8 | | | 36 | | | 360 |
| 38769 | 15/16 | 49 | 36 | | | | 420 |
| 38770 | 1 | | 37 | 37 | | | 430 |
| 38771 | 1.1/16 | | 39 | 36 | 24 | | 450 |
| 38772 | 1.1/8 | | | | | | 480 |
| 38773 | 1.3/16 | | 42 | 38 | | | 520 |
| 38774 | 1.1/4 | 54 | 45 | | 29 | | 580 |
| 38775 | 1.7/16 | | 50 | 42 | 31 | 6 | 660 |
| 38776 | 1.1/2 | 56 | 52 | | 30 | | 720 |
| 38777 | 1.9/16 | | 55 | 45 | | | 760 |
| 38778 | 1.5/8 | 60 | 56 | | 34 | | 810 |
| 38779 | 1.3/4 | | 61 | | | | 860 |
| 38780 | 1.13/16 | 66 | 62 | | 40 | | 920 |
| 38781 | 1.7/8 | | 66 | 48 | | | 980 |
| 38782 | 2 | 68 | 68 | | 42 | | 1080 |
| 38783 | 2.3/16 | 74 | 75 | 53 | 38 | | 1400 |
| 38784 | 2.3/8 | 78 | 83 | 57 | 40 | | 1650 |



10

HERRAMIENTA INOX
INOX (STAINLESS STEEL) TOOLS
OUTILLAGE INOX
INOX WERKZEUGE
UTENSILI INOX
FERRAMENTA INOX
ИНСТРУМЕНТ ИЗ НЕРЖАВЕЮЩЕЙ СТАЛИ



3/4"

■ 12 PT.

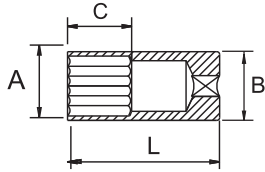

| COD. | AF inch | L (mm) | A (mm) | B (mm) | C (mm) | Pt | g |
|-------|---------|--------|--------|--------|--------|----|------|
| 38804 | 3/4 | | 30 | | | | 320 |
| 38805 | 13/16 | | 33 | 36 | 29 | | 350 |
| 38806 | 7/8 | | | | | | 360 |
| 38807 | 15/16 | | 36 | | | | 420 |
| 38808 | 1 | 49 | 37 | 37 | | | 430 |
| 38809 | 1.1/16 | | 39 | 36 | 24 | | 450 |
| 38810 | 1.1/8 | | 42 | | | | 480 |
| 38811 | 1.3/16 | | | 38 | | | 520 |
| 38812 | 1.1/4 | 54 | 45 | | 29 | | 580 |
| 38813 | 1.7/16 | | 50 | 42 | 31 | 12 | 660 |
| 38814 | 1.1/2 | 56 | 52 | | 30 | | 720 |
| 38815 | 1.9/16 | | 55 | 45 | | | 760 |
| 38816 | 1.5/8 | 60 | 56 | | 34 | | 810 |
| 38817 | 1.3/4 | | 61 | | | | 860 |
| 38818 | 1.13/16 | 66 | 62 | | 40 | | 920 |
| 38819 | 1.7/8 | | 66 | 48 | | | 980 |
| 38820 | 2 | 68 | 68 | | 42 | | 1080 |
| 38821 | 2.3/16 | 74 | 75 | 53 | 38 | | 1400 |
| 38822 | 2.3/8 | 78 | 83 | 57 | 40 | | 1650 |



■ ALARGADERA / EXTENSION / RALLONGE / VERLÄNGERUNG / PROLUNGA / EXTENCAO / УДЛИНИТЕЛЬ

| COD. | AF inch | L (inch) | g |
|-------|---------|----------|-----|
| 38826 | | 4 | 200 |
| 38827 | 3/4 | 8 | 230 |
| 38828 | | 10 | 260 |



■ DESTORNILLADORES / SCREWDRIVERS / TOURNEVIS / SCHRAUBENDREHER / CACCIAVITI / CHAVES DE FENDA / ОТВЕРТКИ

■ ELECTRICISTA / ELECTRICIAN / ELECTRICIEN / ELEKTRIKER / PER ELETTICISTI / ELETRICISTA / ЭЛЕКТРИЧЕСКАЯ

| COD. | mm | mm | mm | g |
|-------|-----|----|-----|-----|
| 38150 | 80 | 3 | 75 | 40 |
| 38151 | | 4 | | 60 |
| 38152 | 100 | 5 | 90 | 90 |
| 38153 | | 6 | 110 | 130 |
| 38154 | 150 | 8 | | 170 |
| 38155 | | 10 | | 200 |
| 38156 | 200 | 12 | 120 | 260 |
| 38157 | 250 | 14 | | 320 |



| COD. | mm | mm | mm | g |
|-------|-----|----|-----|-----|
| 38017 | 80 | 3 | 75 | 40 |
| 38018 | | 4 | | 60 |
| 38019 | 100 | 5 | 90 | 90 |
| 38020 | | 6 | 110 | 130 |
| 38021 | 150 | 8 | | 170 |
| 38022 | | 10 | | 200 |
| 38023 | 200 | 12 | 120 | 220 |
| 38024 | 300 | 10 | | 260 |
| 38025 | 200 | 12 | | 260 |
| 38025 | 250 | 14 | | 320 |



Si no encuentra el artículo que necesita, consúltenos en info@egamaster.com o en www.egamaster.com
 If you can't find the item you look for, please ask us in info@egamaster.com or in www.egamaster.com
 Si vous ne trouvez pas l'article que vous desirez, consultez-nous a info@egamaster.com ou a www.egamaster.com

